

FLO-TREX VALVES STRAIGHT AND ANGLED SIZES 2.5"- 12" | SUBMITTAL

File No: 35-54
Date: AUGUST 02, 2019
Supersedes: 35-54
Date: FEBRUARY 23, 2010

Job: _____ Representative: _____
 _____ Ordered by: _____ Date: _____
 Engineer: _____ Submitted by: _____ Date: _____
 Contractor: _____ Approved by: _____ Date: _____

FLO-TREX VALVE SCHEDULE									
PUMP NO.	QTY.	FTV-F MODEL AND SIZE	CONFIGURATION		ANSI FLANGE RATING (PSIG)		INSULATION (OPTIONAL) CHECK IF REQUIRED		PUMP DESCRIPTION
			STRAIGHT	ANGLED	ANSI 125	ANSI 250	STRAIGHT	ANGLED	

MATERIALS OF CONSTRUCTION

ANSI flange rating 125 psi 250 psi

Body Cast iron ASTM Ductile iron ASTM A536
A48 class 30 grade 65-45-12

Disc Bronze ASTM B584-C84400

Seat EPDM^①

Stem Stainless steel ASTM A582 type 416

Spring Stainless steel ASTM A313 type 302

O-rings Buna (stem) elastomers & EPDM

Metering ports (2) Brass body with EPDM check and gasketed cap

Drain tappings (2) ¼" NPT with brass plug

Insulation (optional) PVC white cover with mineral fiberglass insulation which meets or exceeds ASTM D1784 class 14253-C, MEA #7-87, ASTM E84 and ASTM E136 and flame rating of 25 or less and smoke rating of 50 or less.

MAXIMUM PUMP OPERATING CONDITIONS

- ANSI 125**
175 psig at 150°F (12 bar at 65°C)
100 psig at 300°F (7 bar at 150°C)
- ANSI 250**
375 psig at 150°F (26 bar at 65°C)
260 psig at 300°F (21 bar at 150°C)

PRESSURE TEMPERATURE LIMITS

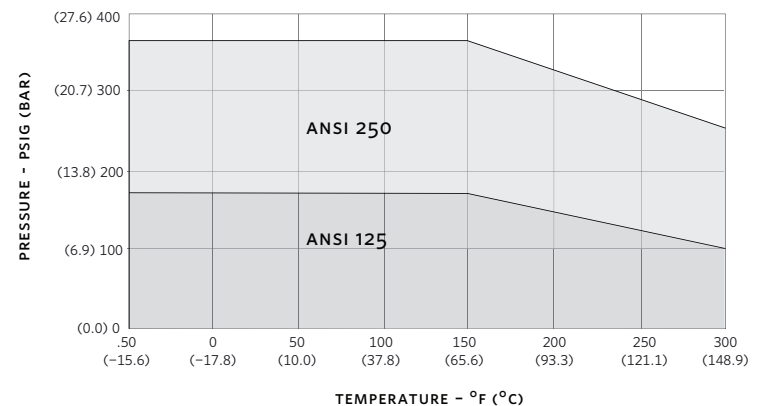

① EPDM Elastomers are not suitable for oil service.

Flo-trex valves
Straight and angle sizes 2.5" - 12"

SUBMITTAL

2

MODEL NUMBER	PART NUMBER	RATING	CONNECTION	TYPE	CONNECTION	DIMENSIONS inches (mm)								WEIGHT lbs (kgs)
						A	B	C	D	ØE	F	H	ØK	
FTV-2.5FS	570200-376	ANSI 125	Flanged	Straight	2.50 (64)	11.90 (302)	7.00 (178)	2.69 (68)	-	0.88 (22)	2.56 (65)	-	7.00 (178)	33.0 (14.9)
FTV-3FS	570200-377	ANSI 125	Flanged	Straight	3.00 (76)	11.69 (297)	7.81 (198)	2.51 (64)	-	0.88 (22)	3.00 (76)	-	7.50 (191)	39.0 (17.7)
FTV-4FS	570200-378	ANSI 125	Flanged	Straight	4.00 (102)	13.96 (355)	8.00 (203)	3.12 (79)	-	1.13 (29)	3.42 (87)	-	9.00 (229)	59.0 (26.7)
FTV-5FS	570200-379	ANSI 125	Flanged	Straight	5.00 (127)	17.38 (441)	10.13 (257)	3.74 (95)	-	1.13 (29)	4.77 (121)	-	10.00 (254)	108.0 (49.0)
FTV-6FS	570200-380	ANSI 125	Flanged	Straight	6.00 (152)	20.59 (523)	10.38 (264)	4.52 (115)	-	1.75 (44)	5.90 (150)	-	11.00 (279)	167.0 (75.8)
FTV-8FS	570200-381	ANSI 125	Flanged	Straight	8.00 (203)	27.80 (706)	18.75 (476)	5.69 (145)	-	1.88 (48)	7.88 (200)	-	13.50 (343)	344.0 (156.0)
FTV-10FS	570200-382	ANSI 125	Flanged	Straight	10.00 (254)	30.01 (762)	24.00 (610)	6.63 (168)	-	1.88 (48)	9.53 (242)	-	16.00 (406)	603.0 (323.0)
FTV-12FS	570200-383	ANSI 125	Flanged	Straight	12.00 (305)	38.03 (966)	26.25 (667)	7.65 (194)	-	1.88 (48)	12.63 (321)	-	19.00 (483)	1006.0 (456.3)
FTV-2.5FA	570200-476	ANSI 125	Flanged	Angled	2.50 (64)	-	7.00 (178)	2.69 (68)	4.64 (118)	0.88 (22)	2.56 (65)	7.17 (182)	7.00 (178)	33.0 (14.9)
FTV-3FA	570200-477	ANSI 125	Flanged	Angled	3.00 (76)	-	7.81 (198)	2.51 (64)	3.64 (92)	0.88 (22)	3.00 (76)	8.01 (203)	7.50 (191)	39.0 (17.7)
FTV-4FA	570200-478	ANSI 125	Flanged	Angled	4.00 (102)	-	8.00 (203)	3.12 (79)	4.38 (111)	1.13 (29)	3.42 (87)	9.58 (243)	9.00 (229)	59.0 (26.7)
FTV-5FA	570200-479	ANSI 125	Flanged	Angled	5.00 (127)	-	10.13 (257)	3.74 (95)	5.43 (138)	1.13 (29)	4.77 (121)	11.97 (304)	10.00 (254)	108.0 (49.0)
FTV-6FA	570200-480	ANSI 125	Flanged	Angled	6.00 (152)	-	10.38 (264)	4.52 (115)	6.49 (165)	1.75 (44)	5.90 (150)	14.10 (358)	11.00 (279)	167.0 (75.8)
FTV-8FA	570200-481	ANSI 125	Flanged	Angled	8.00 (203)	-	18.75 (476)	5.69 (145)	8.79 (223)	1.88 (48)	7.88 (200)	18.94 (481)	13.50 (343)	344.0 (156.0)
FTV-10FA	570200-482	ANSI 125	Flanged	Angled	10.00 (254)	-	24.00 (610)	6.63 (168)	9.77 (248)	1.88 (48)	9.53 (242)	20.33 (516)	16.00 (406)	603.0 (323.0)
FTV-12FA	570200-483	ANSI 125	Flanged	Angled	12.00 (305)	-	26.25 (667)	7.65 (194)	14.04 (357)	1.88 (48)	12.63 (321)	24.02 (610)	19.00 (483)	1006.0 (456.3)
FTV-2.5GS	570200-386	ANSI 125 & ANSI 250	Grooved	Straight	2.50 (64)	12.04 (306)	7.00 (178)	2.69 (68)	-	0.88 (22)	2.56 (65)	-	2.88 (73)	19.0 (8.6)
FTV-3GS	570200-387	ANSI 125 & ANSI 250	Grooved	Straight	3.00 (76)	11.96 (304)	7.81 (198)	2.41 (61)	-	0.88 (22)	3.00 (76)	-	3.50 (89)	24.0 (10.9)
FTV-4GS	570200-388	ANSI 125 & ANSI 250	Grooved	Straight	4.00 (102)	14.01 (356)	8.00 (203)	3.01 (76)	-	1.13 (29)	3.41 (87)	-	4.52 (115)	42.0 (19.1)
FTV-5GS	570200-389	ANSI 125 & ANSI 250	Grooved	Straight	5.00 (127)	17.52 (445)	10.13 (257)	3.61 (92)	-	1.13 (29)	4.77 (121)	-	5.58 (142)	81.0 (36.7)
FTV-6GS	570200-390	ANSI 125 & ANSI 250	Grooved	Straight	6.00 (152)	20.81 (529)	10.38 (264)	4.52 (115)	-	1.75 (44)	5.90 (150)	-	6.63 (168)	120.0 (54.0)
FTV-8GS	570200-391	ANSI 125 & ANSI 250	Grooved	Straight	8.00 (203)	27.96 (710)	18.75 (476)	5.69 (145)	-	1.88 (48)	7.88 (200)	-	8.63 (219)	288.6 (130.90)
FTV-10GS	570200-392	ANSI 125 & ANSI 250	Grooved	Straight	10.00 (254)	30.01 (762)	24.00 (610)	6.63 (168)	-	1.88 (48)	9.53 (242)	-	10.75 (273)	458.5 (208.0)
FTV-12GS	570200-393	ANSI 125 & ANSI 250	Grooved	Straight	12.00 (305)	38.10 (968)	26.25 (667)	7.65 (194)	-	1.88 (48)	12.63 (321)	-	12.75 (324)	818.1 (371.1)
FTV-2.5GA	570200-486	ANSI 125 & ANSI 250	Grooved	Angled	2.50 (64)	-	7.00 (178)	2.69 (68)	4.63 (118)	0.88 (22)	2.56 (65)	7.35 (187)	2.88 (73)	19.0 (8.6)
FTV-3GA	570200-487	ANSI 125 & ANSI 250	Grooved	Angled	3.00 (76)	-	7.81 (198)	2.41 (61)	3.77 (96)	0.88 (22)	3.00 (76)	8.15 (207)	3.50 (89)	24.0 (10.9)
FTV-4GA	570200-488	ANSI 125 & ANSI 250	Grooved	Angled	4.00 (102)	-	8.00 (203)	3.01 (76)	4.42 (112)	1.13 (29)	3.41 (87)	9.60 (244)	4.52 (115)	42.0 (19.1)
FTV-5GA	570200-489	ANSI 125 & ANSI 250	Grooved	Angled	5.00 (127)	-	10.13 (257)	3.61 (92)	5.47 (139)	1.13 (29)	4.77 (121)	12.07 (307)	5.58 (142)	81.0 (36.7)
FTV-6GA	570200-490	ANSI 125 & ANSI 250	Grooved	Angled	6.00 (152)	-	10.38 (264)	4.52 (115)	6.64 (169)	1.75 (44)	5.90 (150)	14.17 (360)	6.63 (168)	120.0 (54.0)
FTV-8GA	570200-491	ANSI 125 & ANSI 250	Grooved	Angled	8.00 (203)	-	18.75 (476)	5.69 (145)	8.93 (227)	1.88 (48)	7.88 (200)	18.96 (482)	8.63 (219)	288.6 (130.90)
FTV-10GA	570200-492	ANSI 125 & ANSI 250	Grooved	Angled	10.00 (254)	-	24.00 (610)	6.63 (168)	9.77 (248)	1.88 (48)	9.53 (242)	20.33 (516)	10.75 (273)	458.5 (208.0)
FTV-12GA	570200-493	ANSI 125 & ANSI 250	Grooved	Angled	12.00 (305)	-	26.25 (667)	7.65 (194)	14.05 (357)	1.88 (48)	12.63 (321)	24.08 (612)	12.75 (324)	818.1 (371.1)
FTV-8HFS	570200-661	ANSI 250	Flanged	Straight	8.00 (203)	27.96 (710)	18.75 (476)	5.69 (145)	-	1.88 (48)	7.88 (200)	-	14.82 (376)	396.0 (179.6)
FTV-10HFS	570200-662	ANSI 250	Flanged	Straight	10.00 (254)	30.01 (762)	24.00 (610)	6.63 (168)	-	1.88 (48)	9.53 (242)	-	17.50 (445)	712.0 (323.0)
FTV-12HFS	570200-663	ANSI 250	Flanged	Straight	12.00 (305)	37.99 (965)	26.25 (667)	7.65 (194)	-	1.88 (48)	12.63 (321)	-	20.50 (521)	1163.0 (527.5)
FTV-8HFA	570200-681	ANSI 250	Flanged	Angled	8.00 (203)	-	18.75 (476)	5.69 (145)	8.87 (225)	1.88 (48)	7.88 (200)	19.02 (483)	14.82 (376)	344.0 (156.0)
FTV-10HFA	570200-682	ANSI 250	Flanged	Angled	10.00 (254)	-	24.00 (610)	6.63 (168)	9.77 (248)	1.88 (48)	9.53 (242)	20.33 (516)	17.50 (445)	712.0 (323.0)
FTV-12HFA	570200-683	ANSI 250	Flanged	Angled	12.00 (305)	-	26.25 (667)	7.65 (194)	14.02 (356)	1.88 (48)	12.63 (321)	24.00 (610)	20.50 (521)	1163.0 (527.5)

- Dimensions and weights are for reference only. Dimensions are inches (mm) and weights are lbs (kg).
- Tolerance of ±0.125" (±3 mm) should be used
- For exact installation data, please write factory for certified dimensions

FLANGED, STRAIGHT - MODEL FTV-FS

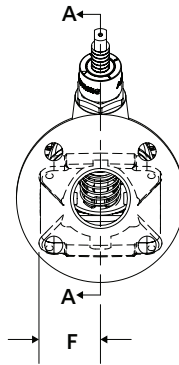
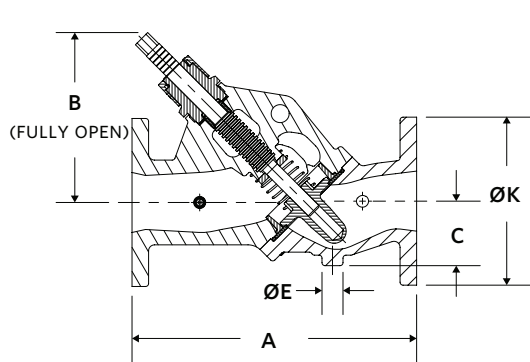

FLANGED, ANGLED - MODEL FTV-FA

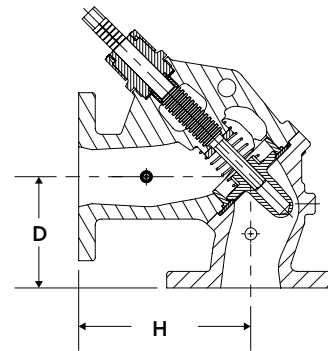

GROOVED STRAIGHT - MODEL FTV-GS

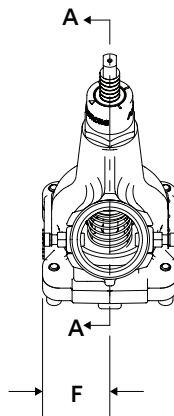
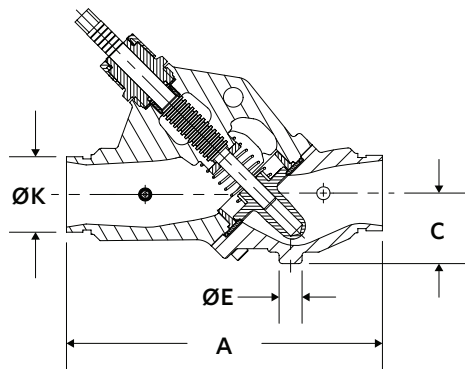

GROOVED ANGLED - MODEL FTV-GA

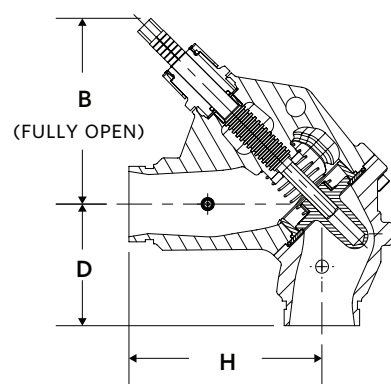

TORONTO

23 BERTRAND AVENUE
TORONTO, ONTARIO
CANADA, M1L 2P3
+1 416 755 2291

BUFFALO

93 EAST AVENUE
NORTH TONAWANDA, NEW YORK
U.S.A., 14120-6594
+1 716 693 8813

BIRMINGHAM

HEYWOOD WHARF, MUCKLOW HILL
HALESOWEN, WEST MIDLANDS
UNITED KINGDOM, B62 8DJ
+44 (0) 8444 145 145

MANCHESTER

WOLVERTON STREET
MANCHESTER
UNITED KINGDOM, M11 2ET
+44 (0) 8444 145 145

BANGALORE

#59, FIRST FLOOR, 3RD MAIN
MARGOSA ROAD, MALLESWARAM
BANGALORE, INDIA, 560 003
+91 (0) 80 4906 3555

SHANGHAI

UNIT 903, 888 NORTH SICHUAN RD.
HONGKOU DISTRICT, SHANGHAI
CHINA, 200085
+86 (0) 21 5237 0909

SÃO PAULO

RUA JOSÉ SEMIÃO RODRIGUES AGOSTINHO,
1370 GALPÃO 6 EMBU DAS ARTES
SAO PAULO, BRAZIL
+55 11 4785 1330

LYON

93 RUE DE LA VILLETTE
LYON, 69003 FRANCE
+33 (0) 420 102 625

DUBAI

LOB16, #611, JAFZA
P.O. BOX 18226
DUBAI - UNITED ARAB EMIRATES
+971 4 887 6775

MANNHEIM

DYNAMOSTRASSE 13
68165 MANNHEIM
GERMANY
+49 (0) 621 3999 9858